



# Gatwick Airport Northern Runway Project

Environmental Statement

Appendix 5.3.2: Code of Construction Practice Annex 6 – Outline Arboricultural and Vegetation

Method Statement – Part 2 - Tracked Version

**Book 5**

VERSION: 4.0

DATE: JULY 2024

Application Document Ref: 5.3

PINS Reference Number: TR020005



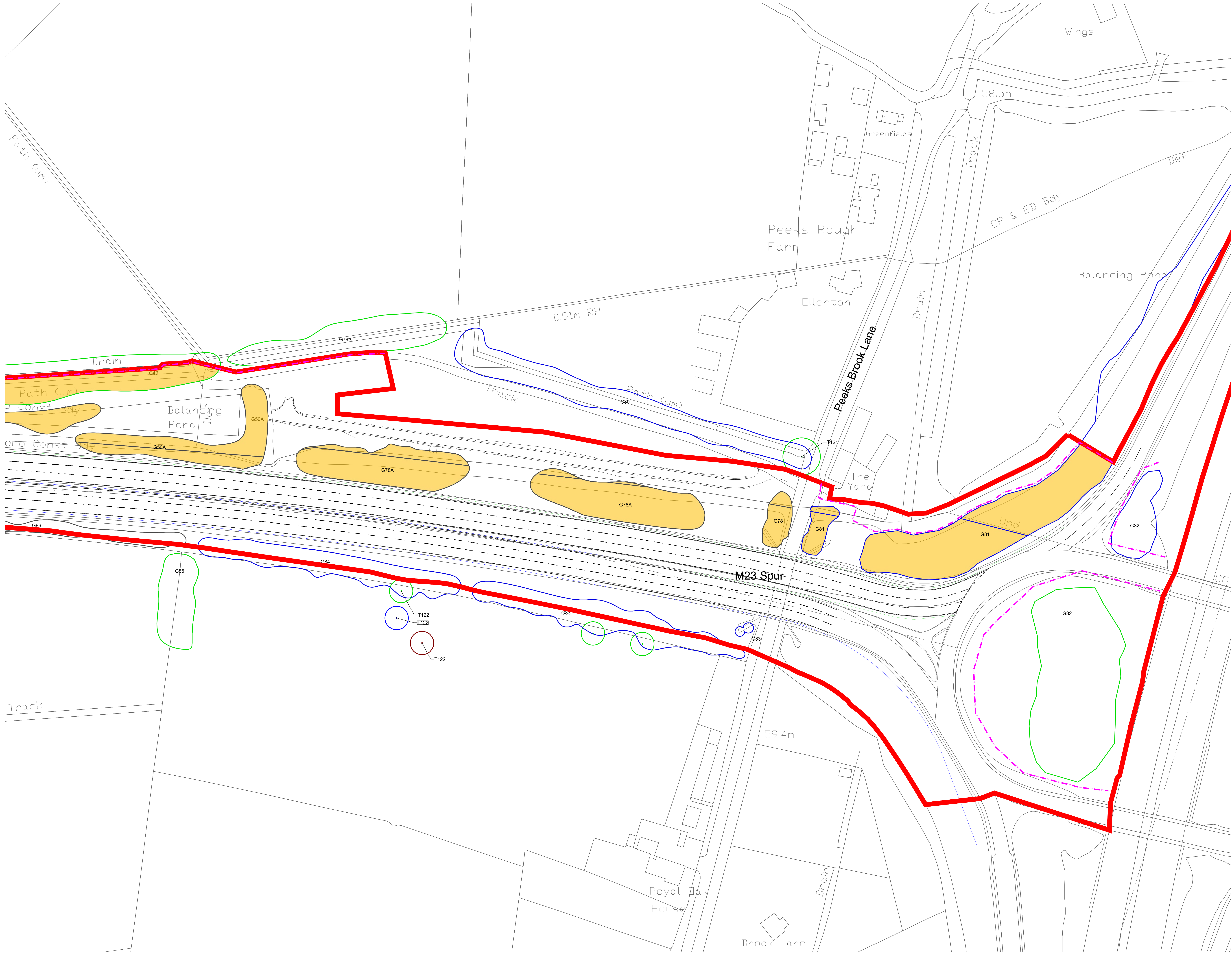

### Key

- Site Boundary
- Survey Boundary / Boundary of M23/A23 construction activity
- Indicative temporary protective fence line in accordance with Section 6.2 - BS5837:2012. See below for example barriers.
- Indicative vegetation protective fence line: Design and location to be agreed by local council during detail design.
- Projected tree loss required for construction of the Project (worst case scenario)
- Tree with numbered reference. Canopy spread and coloured BS5837:2012 tree quality category as shown below.
  - # = Tree details estimate (inaccessible tree)
  - \* = Tree in off site location
- Vegetation group with numbered reference. Canopy extents and BS5837:2012 tree quality category as shown below.
- Hedge with numbered reference. Width and BS5837:2012 tree quality category as shown below.

BS 5837:2012 Tree Quality Categories - Table 1

- Category A - High quality
- Category B - Moderate quality
- Category C - Low quality
- Category U - Unsuitable for retention

Tree protected by Tree Preservation Order. Bracketted number relates to the TPO reference.

NOTE:

- Refer to ES Appendix 8 & 10.1: Tree Survey report and Arboricultural Impact Assessment for further details.

DETAIL A

DETAIL B

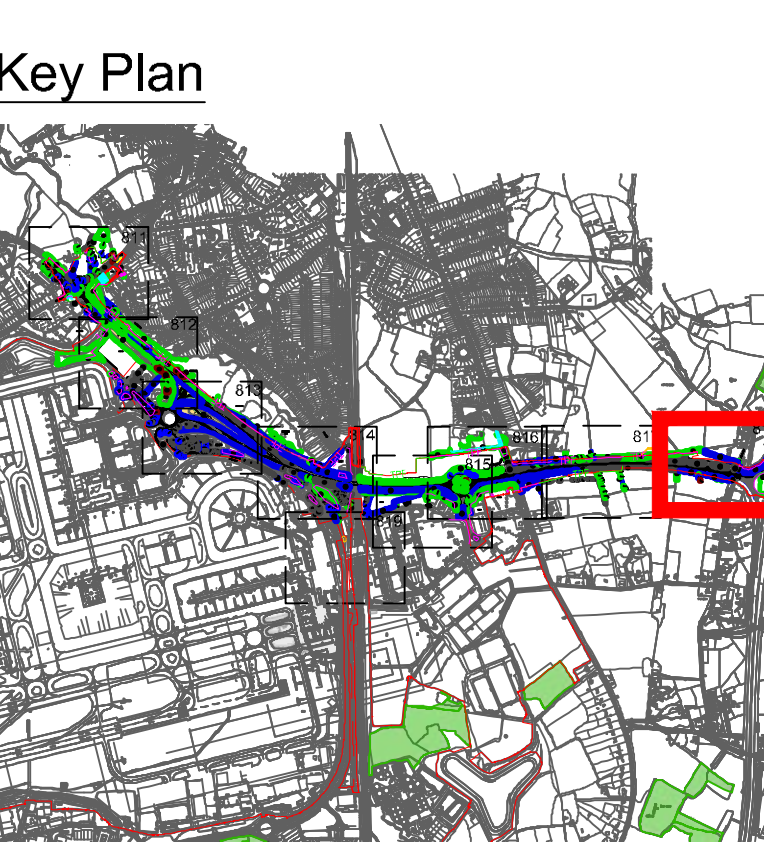

DOCUMENT

**Environmental Statement**

DRAWING TITLE  
**M23 & A23 Preliminary Tree Removal & Protection Plans**  
 Appendix 5.3.2 Annex 6  
 Sheet 8 of 9

DATE  
**June 2024**

ORIENTATION	DRAWING NO.	REVISION
N	818	For ES Issue
	DRAWN BY	PIA / CHECKED BY
	RC	DC

SCALE @ A0  
 0m 25m 50m

Reproduced from Ordnance Survey map with the permission of Ordnance Survey on behalf of the controller of Her Majesty's Stationery Office © Crown Copyright (2023). Licence number 0100031073, 10004998, 10004892.  
 © Copyright 2023 Gatwick Airport Limited. No part of this drawing is to be reproduced without prior permission of Gatwick Airport Limited.



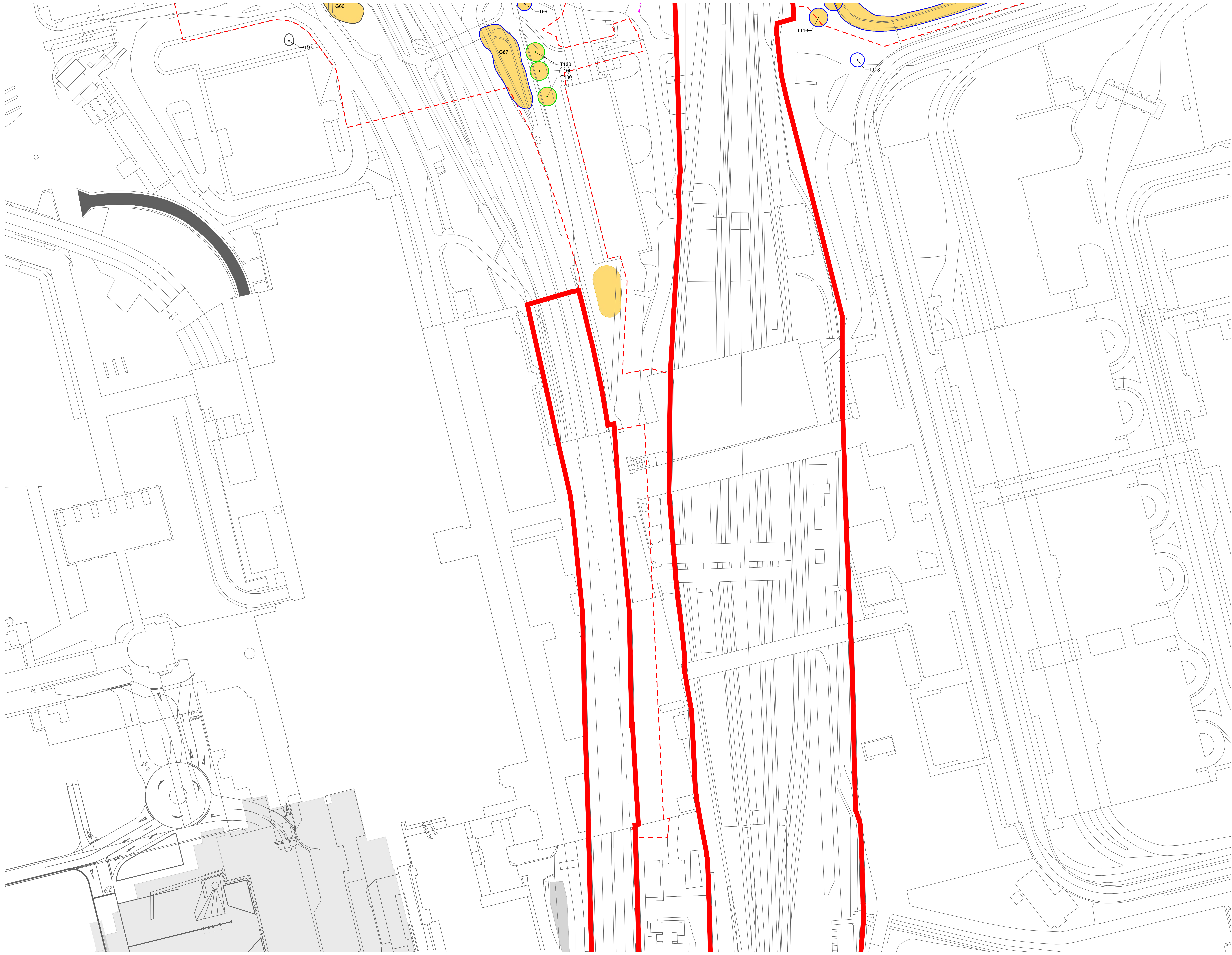

### Key

- Site Boundary
- Survey Boundary / Boundary of M23/A23 construction activity
- Indicative temporary protective fence line in accordance with Section 6.2 - BS5837:2012. See below for example barriers.
- Indicative vegetation protective fence line: Design and location to be agreed by local council during detail design.
- Projected tree loss required for construction of the Project (worst case scenario)
- Tree with numbered reference. Canopy spread and coloured BS5837:2012 tree quality category as shown below.
  - = Tree details estimate (accessible tree)
  - = Tree in off site location
- Vegetation group with numbered reference. Canopy extents and BS5837:2012 tree quality category as shown below.
- Hedge with numbered reference. Width and BS5837:2012 tree quality category as shown below.

**BS 5837:2012 Tree Quality Categories - Table 1**

- Category A - High quality
- Category B - Moderate quality
- Category C - Low quality
- Category U - Unsuitable for retention

Tree protected by Tree Preservation Order. Bracketted number relates to the TPO reference.

**NOTE:**

- Refer to ES Appendix 8.10.1: Tree Survey report and Arboricultural Impact Assessment for further details.

**DETAIL A**  
Tree protection barrier

**DETAIL B**  
Tree protection barrier

**DETAIL C**  
Tree protection barrier

**DETAIL D**  
Tree protection barrier

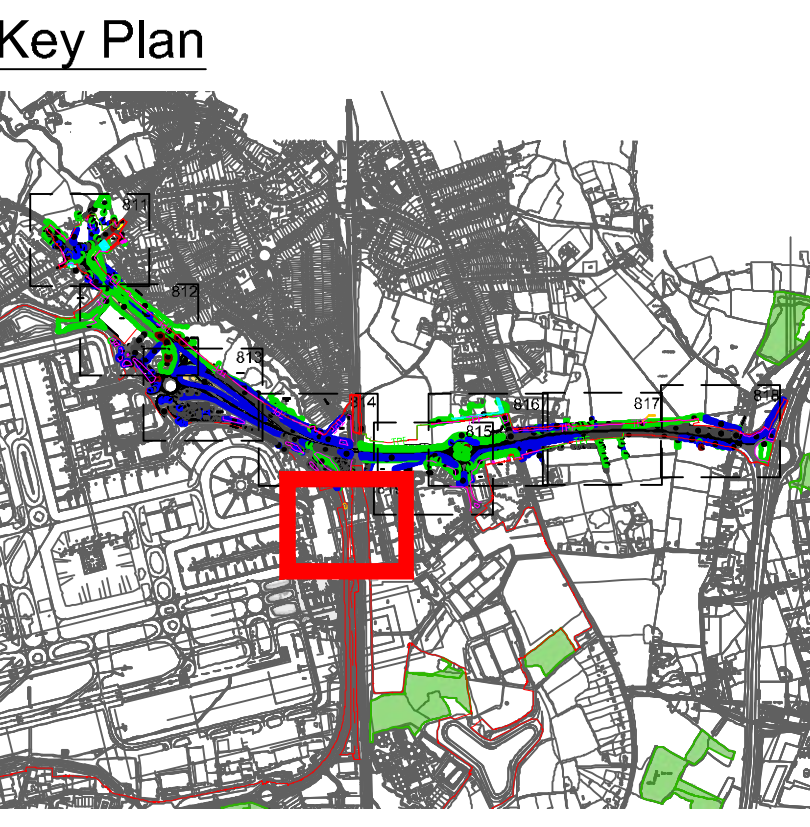

DOCUMENT

**Environmental Statement**

DRAWING TITLE  
**M23 & A23 Preliminary Tree Removal & Protection Plans**  
Appendix 5.3.2 Annex 6  
Sheet 9 of 9

DATE  
**June 2024**

ORIENTATION	DRAWING NO.	REVISION
N	819	For ES Issue
	DRAWN BY	PM / CHECKED BY
	RC	DC

SCALE @ A0  
0m 25m 50m



**Appendix B**  
**Airport Preliminary Tree Removal & Protection Plans**





### Key

- Site boundary.
- Survey boundary.
- Tree with numbered reference. Canopy spread and coloured BS5837:2012 tree quality category as shown below. # = Tree details estimate (inaccessible tree) = Tree in off site location
- Tree group plotted with individual stem locations and numbered reference. Canopy extents coloured to match BS5837:2012 tree quality category as shown below.
- Tree or Vegetation group with numbered reference. Canopy extents coloured to match BS5837:2012 tree quality category as shown below and dashed line to show indicative stem line.
- Hedge with numbered reference. Canopy extents and coloured BS5837:2012 tree quality category as shown below and dashed line to show hedge centreline.
- Woodland with numbered reference. Canopy extents coloured to match BS5837:2012 tree quality category as shown below and dashed line to show hedge centreline.

**BS 5837:2012 Tree Quality Categories - Table 1**

- Category A - High quality
- Category B - Moderate quality
- Category C - Low quality
- Category U - Unsuitable for retention

- Direction of first significant branch
- Root protection area (RPA) Calculated in accordance with Section 4.6 - BS5837:2012
- Veteran tree buffer (15 x stem Ø) (as per standing advice produced by Forestry England and Natural England)
- Tree protected by Tree Preservation Order. Bracketted number relates to the TPO reference.
- Designated Ancient Woodland (as per Natural England ancient woodland inventory, via open data publication)
- Ancient Woodland tree buffer (15m offset) (as per standing advice produced by Forestry England and Natural England)
- Projected tree loss required for construction of the Project (worst case scenario)
- Indicative Scheme Layout
- Indicative temporary protective fence/line in accordance with Section 6.2 - BS5837:2012. See below for example barriers.
- Indicative secondary protective Hi-Vis Mesh fence/line in accordance with Section 6.2 - BS5837:2012. See below for example barriers.
- Indicative vegetation protective fence/line. Design and location to be agreed by local council during detail design.

**NOTES:**

- Refer to ES Appendix 6.10.1. Tree Survey Report and Arboricultural Impact Assessment for further details.
- Survey based on a visual inspection from the ground and is not intended as a full arboricultural inspection.
- Plan produced in accordance with recommendations set out in BS 5837:2012. Trees in Relation to design, demolition and construction.
- Survey based upon Aerial Photography and trees located by eye.

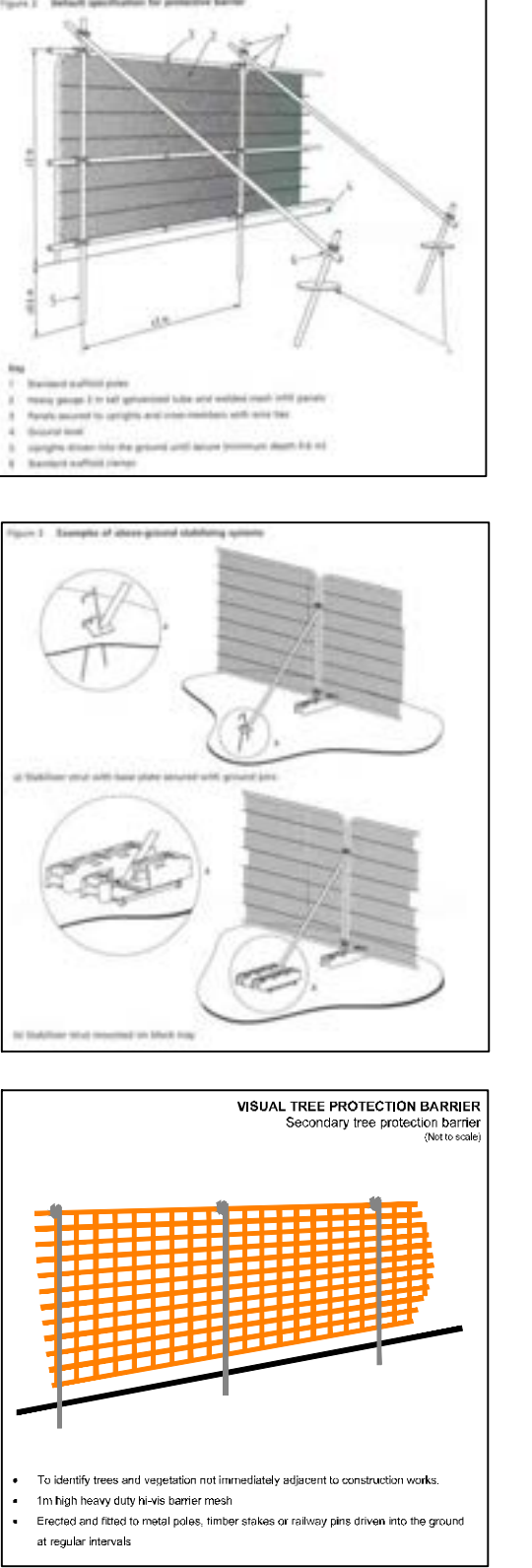

DOCUMENT

**Environmental Statement**

DRAWING TITLE  
**Airport Preliminary Tree Removal & Protection Plans Appendix 5.3.2 Annex 6 Overview**

DATE  
**June 2024**

ORIENTATION	DRAWING NO.	REVISION
N	735	For ES Issue
	DRAWN BY	PIA / CHECKED BY
	RC	DC

SCALE @ A0  
**Custom Scale**

Reproduced from Ordnance Survey maps with the permission of Ordnance Survey on behalf of the controller of Her Majesty's Stationery Office © Crown Copyright (2023). Licence number 610031673. 10004892.  
© Copyright 2023 Gatwick Airport Limited. No part of this drawing is to be reproduced without prior permission of Gatwick Airport Limited.



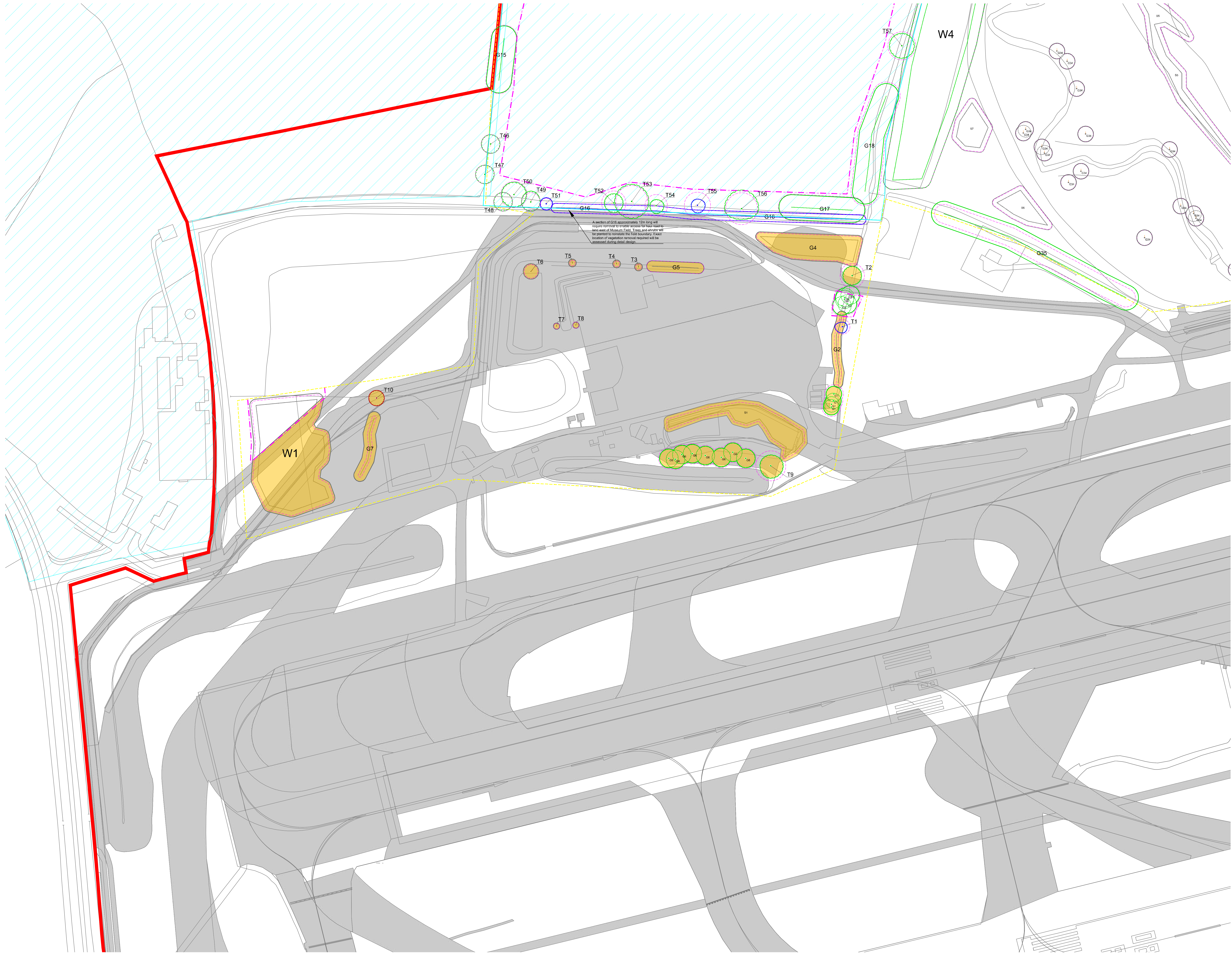

- Key**
- Site boundary
  - Survey boundary
  - Tree with numbered reference. Canopy spread and colour to match BS5837:2012 tree quality category as shown below.
    - = Tree details estimate (measurable tree)
    - = Tree in off site location
  - Tree group plotted with individual stem locations and numbered references. Canopy extents coloured to match BS5837:2012 tree quality category as shown below
  - Tree or vegetation group with numbered reference. Canopy extents coloured to match BS5837:2012 tree quality category as shown below and dashed line to show indicative stem line.
  - Hedge with numbered reference. Canopy extents and colour to match BS5837:2012 tree quality category as shown below and dashed line to show hedge centreline.
  - Woodland with numbered reference. Canopy extents coloured to match BS5837:2012 tree quality category as shown below and dashed line to show indicative tree line.
- BS 5837:2012 Tree Quality Categories - Table 1
- Category A - High quality
  - Category B - Moderate quality
  - Category C - Low quality
  - Category U - Unsuitable for retention
- Direction of first significant branch
  - Root protection area (RPA). Calculated in accordance with Section 6.1 of BS5837:2012
  - Vegetation tree buffer (15m from B) (as per standing advice produced by Forestry England and Natural England)
  - Tree protected by Tree Preservation Order. Bracketed number relates to the TPO reference.
  - Designated Ancient Woodland (as per Natural England ancient woodland inventory, via open data publication)
  - Ancient Woodland tree buffer (15m offset) (as per standing advice produced by Forestry England and Natural England)
  - Protected tree trees required for construction of the Project (worst case scenario)
  - Indicative Scheme Layout
  - Indicative temporary protective fence/line in accordance with Section 6.2 - BS5837:2012. See below for example barriers.
  - Indicative secondary protective H/W Mesh fence/line in accordance with Section 6.2 - BS5837:2012. See below for example barriers.
  - Indicative vegetation protective fence/line; Design and location to be agreed by local council during detail design.

- NOTES:**
- Refer to ES Appendix 6.10.1: Tree Survey Report and Arboricultural
  - Survey Assessment for further details.
  - The general location of trees shown on this plan is for information only and is not intended as a final arboreal survey.
  - The general location of trees shown on this plan is for information only and is not intended as a final arboreal survey.
  - BS5837:2012 - "Trees in relation to design, demolition and construction"
  - Survey Assessment Appendix 6.10.1: Tree Survey Report
- 

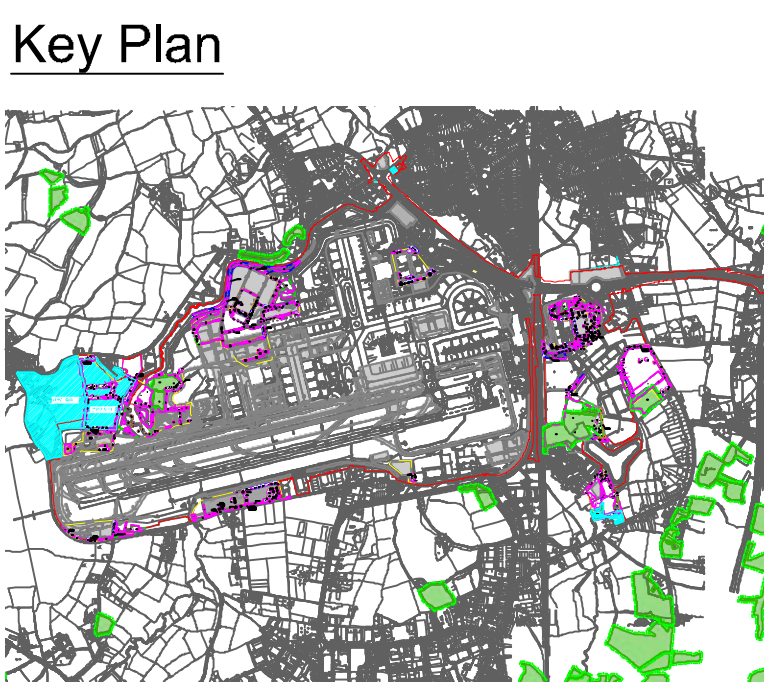

**DOCUMENT**

**Environmental Statement**

DRAWING TITLE  
**Airport Preliminary Tree Removal & Protection Plans**  
 Appendix 5.3.2 Annex 6  
 Sheet 1 of 13

DATE  
 June 2024

ORIENTATION	DRAWING NO.	REVISION
N	750	For ES Issue
	DRAWN BY	PIA / CHECKED BY
	RC	DC

SCALE @ A0

Reproduced from Ordnance Survey map with the permission of Ordnance Survey on behalf of the controller of Her Majesty's Stationery Office © Crown Copyright (2023). Licence number 6100031073, 10004998, 10004892.  
 © Copyright 2023 Gatwick Airport Limited. No part of this drawing is to be reproduced without prior permission of Gatwick Airport Limited.



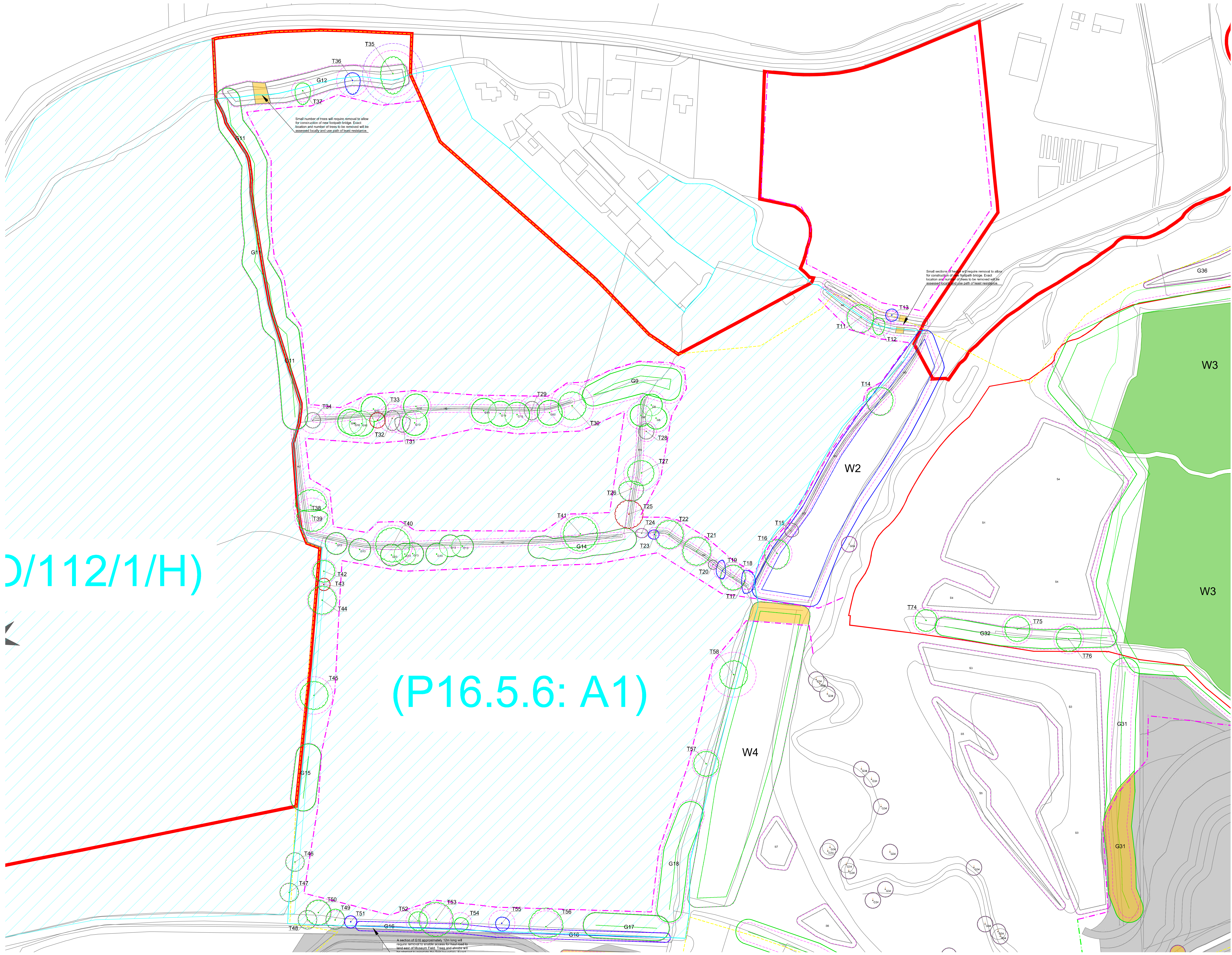

- Key**
- Site boundary
  - Survey boundary
  - Tree with numbered reference. Canopy spread and coloured BS5837:2012 tree quality category as shown below.
    - Tree details estimate (measurable tree)
    - Tree in situ location
  - Tree group plotted with individual stem locations and numbered reference. Canopy extents coloured to match BS5837:2012 tree quality category as shown below.
  - Tree or vegetation group with numbered reference. Canopy extents coloured to match BS5837:2012 tree quality category as shown below and dashed line to show indicative stem line.
  - Hedge with numbered reference. Canopy extents and coloured BS5837:2012 tree quality category as shown below and dashed line to show hedge centreline.
  - Woodland with numbered reference. Canopy extents coloured to match BS5837:2012 tree quality category as shown below and dashed line to show indicative tree line.
- BS 5837:2012 Tree Quality Categories - Table 1
- Category A - High quality
  - Category B - Moderate quality
  - Category C - Low quality
  - Category U - Unsuitable for retention
- Direction of first significant branch
  - Root protection area (RPA) Calculated in accordance with Section 4.6. BS5837:2012
  - Vegetation buffer (15 x stem Ø) (as per standing advice produced by Forestry England and Natural England)
  - Tree protected by Tree Preservation Order. Bracketed number relates to the TPO reference.
  - Designated Ancient Woodland (as per Natural England ancient woodland inventory, via open data publication)
  - Ancient Woodland tree buffer (15m offset) (as per standing advice produced by Forestry England and Natural England)
  - Projected tree loss required for construction of the Project (worst case scenario)
  - Indicative Scheme Layout
  - Indicative temporary protective fencing in accordance with Section 6.2. BS5837:2012. See below for example barriers.
  - Indicative secondary protective H10 Mesh fencing in accordance with Section 6.2. BS5837:2012. See below for example barriers.
  - Indicative vegetation protective fencing. Design and location to be agreed by local council during detail design.

- NOTES:**
- Refer to ES Appendix 6.10.1: Tree Survey Report and Arboricultural
  - Report Assessment for further details.
  - Some areas are on a local authority's land and are not included in the public domain.
  - The work is intended to be used as a guide only and is not a substitute for professional advice.
  - BS5837:2012 - Trees in Relation to Design, Construction and Construction
  - Survey data used where available and where not available, estimated.
- 

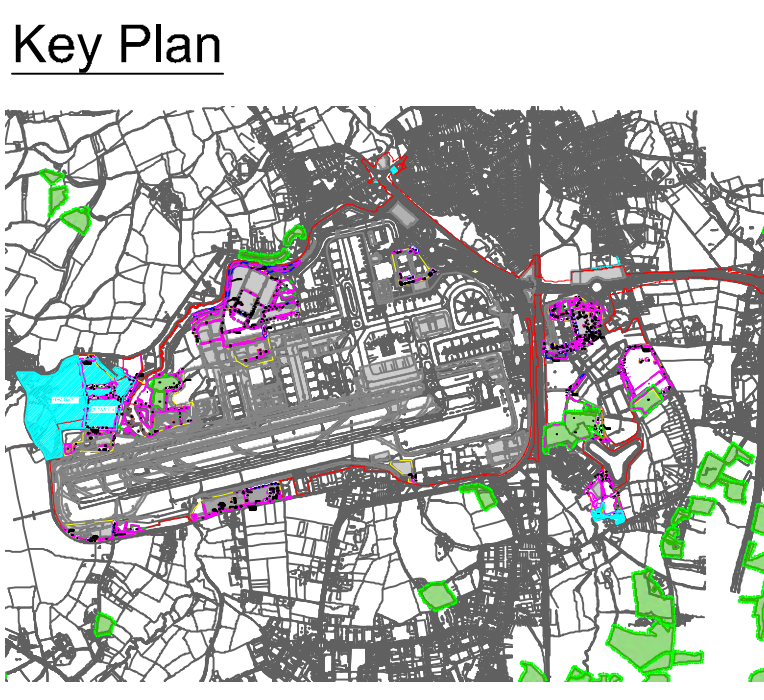

D/112/1/H)

(P16.5.6: A1)

DOCUMENT

**Environmental Statement**

DRAWING TITLE  
**Airport Preliminary Tree Removal & Protection Plans**  
 Appendix 5.3.2 Annex 6  
 Sheet 2 of 13

DATE  
 June 2024

ORIENTATION N	DRAWING NO. 751	REVISION For ES Issue
	DRAWN BY RC	PIA / CHECKED BY DC

SCALE @ A0  
 0m 25m 50m

Reproduced from Ordnance Survey map with the permission of Ordnance Survey on behalf of the controller of Her Majesty's Stationery Office © Crown Copyright (2023). Licence number 010031073. 10004892.  
 © Copyright 2023 Gatwick Airport Limited. No part of this drawing is to be reproduced without prior permission of Gatwick Airport Limited.



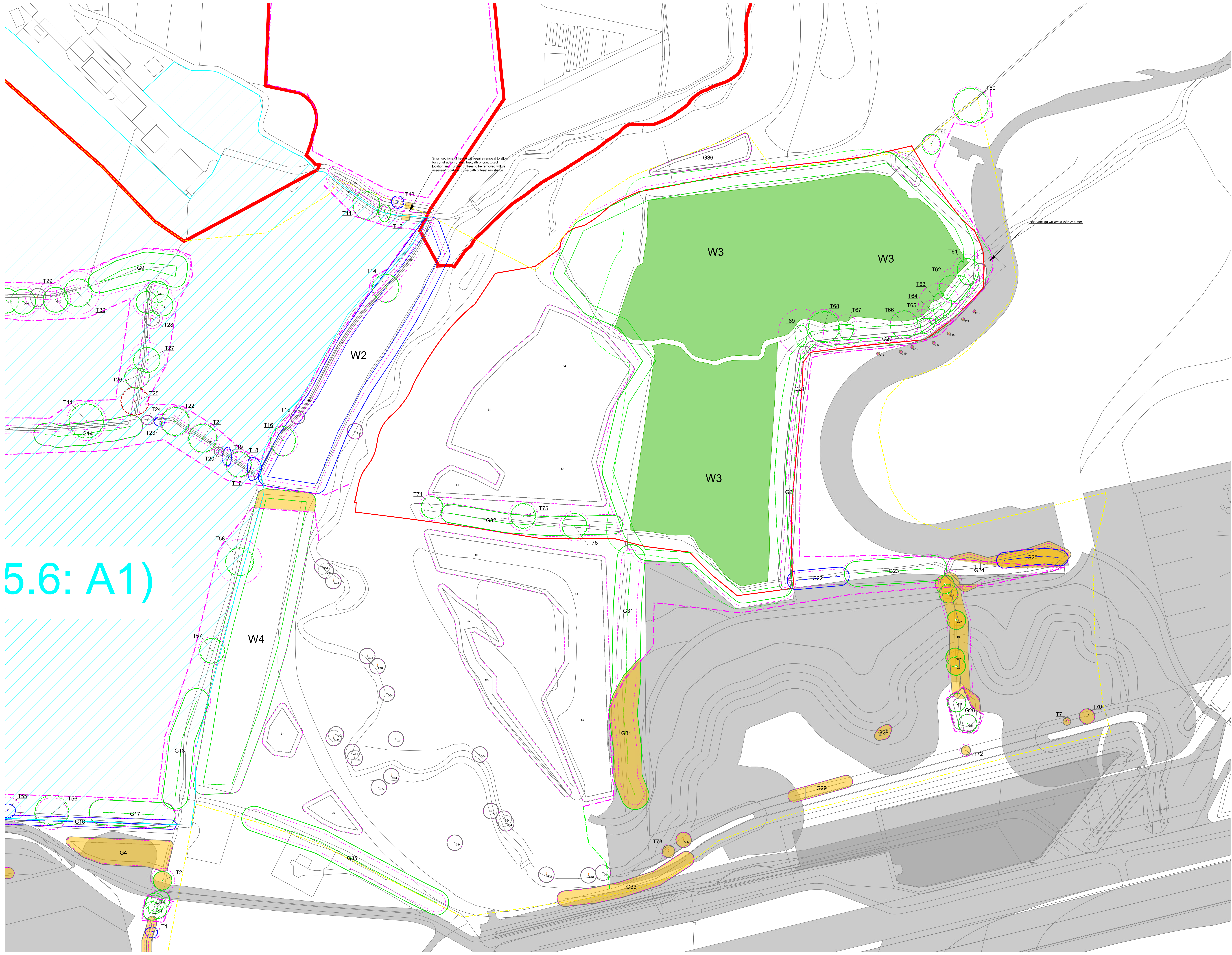

5.6: A1)

**Key**

- Site boundary
- Survey boundary
- Tree with numbered reference. Canopy spread and colour BS5837:2012 tree quality category as shown below.
  - = Tree details estimate (measurable tree)
  - = Tree in site location
- Tree group plotted with individual stem locations and numbered references. Canopy extents coloured to match BS5837:2012 tree quality category as shown below.
- Tree or vegetation group with numbered reference. Canopy extents coloured to match BS5837:2012 tree quality category as shown below and dashed line to show indicative stem line.
- Hedge with numbered reference. Canopy extents and colour BS5837:2012 tree quality category as shown below and dashed line to show hedge centreline.
- Woodland with numbered reference. Canopy extents coloured to match BS5837:2012 tree quality category as shown below and dashed line to show indicative tree line.

BS 5837:2012 Tree Quality Categories - Table 1

- Category A - High quality
- Category B - Moderate quality
- Category C - Low quality
- Category U - Unsuitable for retention

- Direction of first significant branch
- Road protection area (RPA) Calculated in accordance with Section 4.6.1 BS5837:2012
- Vegetation tree buffer (15 x 15m) (as per standing advice produced by Forestry England and Natural England)
- Tree protected by Tree Preservation Order. Bracketed number relates to the TPO reference.
- Designated Ancient Woodland (as per Natural England ancient woodland inventory, via open data publication)
- Ancient Woodland tree buffer (15m offset) (as per standing advice produced by Forestry England and Natural England)
- Protected tree lots required for construction of the Project (best use scenario)
- Indicative Scheme Layout
- Indicative temporary protective fence line in accordance with Section 6.2 BS5837:2012. See below for example barriers.
- Indicative secondary protective H16 Mesh fence line in accordance with Section 6.2 BS5837:2012. See below for example barriers.
- Indicative vegetation protective fence line. Design and location to be agreed by local council during detail design.

**NOTES:**

- Refer to ES Appendix A.10.1: Tree Survey Report and Ancillary Survey
- Some elements are for information only and are not intended as a final construction specification.
- The final construction specification will be set out in the ES Appendix A.10.2: Tree Removal and Protection Plans.
- Some elements are for information only and are not intended as a final construction specification.
- Some elements are for information only and are not intended as a final construction specification.

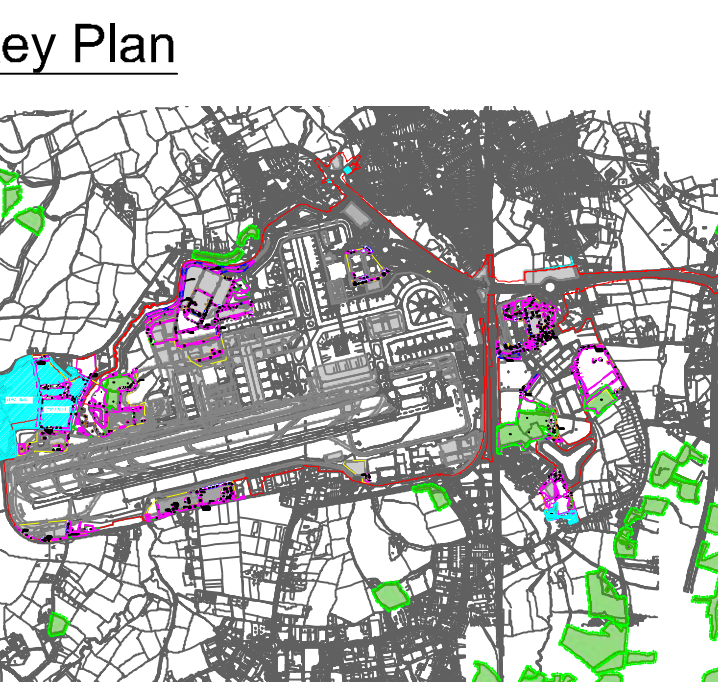
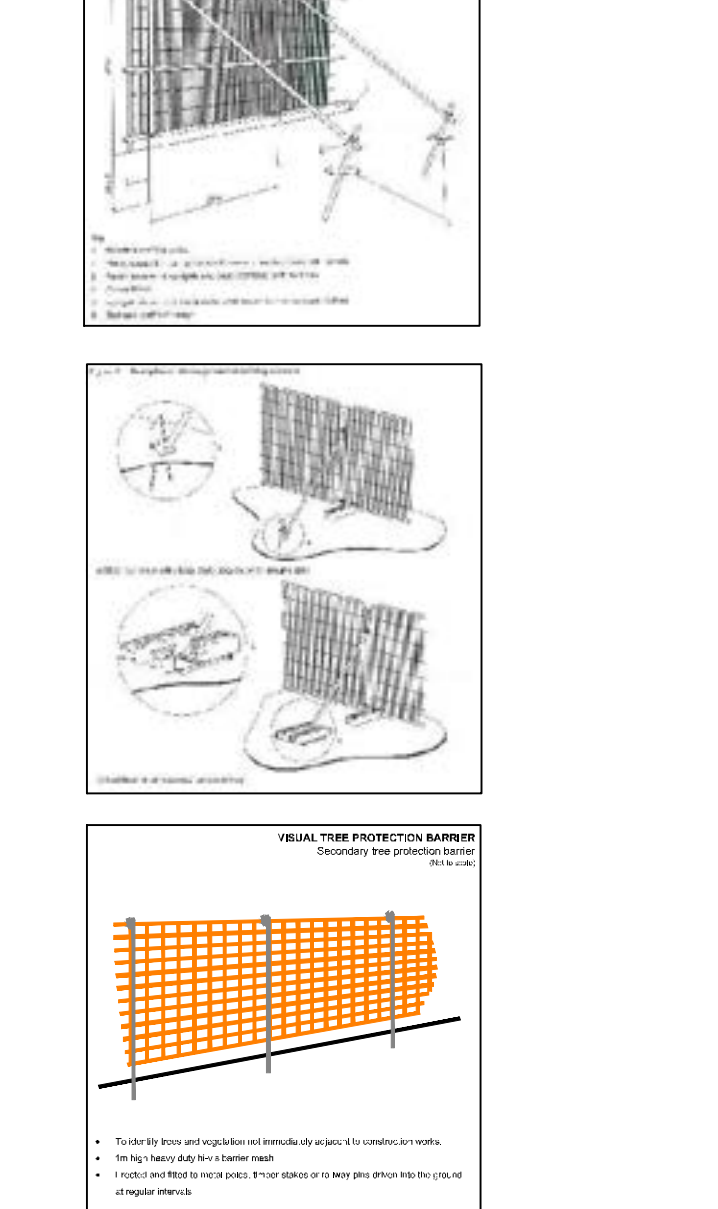

DOCUMENT

**Environmental Statement**

DRAWING TITLE  
**Airport Preliminary Tree Removal & Protection Plans**  
Appendix 5.3.2 Annex 6  
Sheet 3 of 13

DATE  
June 2024

ORIENTATION	DRAWING NO.	REVISION
N	752	For ES Issue
	DRAWN BY	PIA / CHECKED BY
	RC	DC

SCALE @ A0  
0m 25m 50m





- ### Key
- Site boundary
  - Survey boundary
  - Tree with numbered reference. Canopy spread and coloured BS5837:2012 tree quality category as shown below.
    - = Tree details estimate (measurable tree)
    - = Tree on site location
  - Tree group plotted with individual stem locations and numbered reference. Canopy extents coloured to match BS5837:2012 tree quality category as shown below and dashed line to show indicative stem line.
  - Hedge with numbered reference. Canopy extents and coloured BS5837:2012 tree quality category as shown below and dashed line to show hedge centreline.
  - Woodland with numbered reference. Canopy extents coloured to match BS5837:2012 tree quality category as shown below and dashed line to show indicative line.
- BS 5837:2012 Tree Quality Categories - Table 1
- Category A - High quality
  - Category B - Moderate quality
  - Category C - Low quality
  - Category U - Unsuitable for retention
- Direction of first significant branch
  - Root protection area (RPA) Calculated in accordance with Section 4.6.1 BS5837:2012
  - Vegetation tree buffer (15 x stem Ø) (as per standing advice produced by Forestry England and Natural England)
  - Tree protected by Tree Preservation Order. Bracketted number relates to the TPO reference.
  - Designated Ancient Woodland (as per Natural England ancient woodland inventory, via open data publication)
  - Ancient Woodland tree buffer (15m offset) (as per standing advice produced by Forestry England and Natural England)
  - Projected tree loss required for construction of the Project (worst case scenario)
  - Indicative Scheme Layout
  - Indicative temporary protective fence line in accordance with Section 6.2 BS5837:2012. See below for example barriers.
  - Indicative secondary protective H/V Mesh fencing in accordance with Section 6.2 BS5837:2012. See below for example barriers.
  - Indicative vegetation protective fencing. Design and location to be agreed by local council during detail design.

- NOTES:**
- Refer to ES Appendix B.10.1: Tree Survey Report and Arboricultural
  - Some assessments for root protection are shown and are not intended as a full arboricultural report.
  - The final arboricultural report recommendations are set in BS 5837:2012 - 'Trees in Relation to Design, Construction and Construction'.
  - Some areas are shown in red and black to be removed.
- 
- 
- 
- 

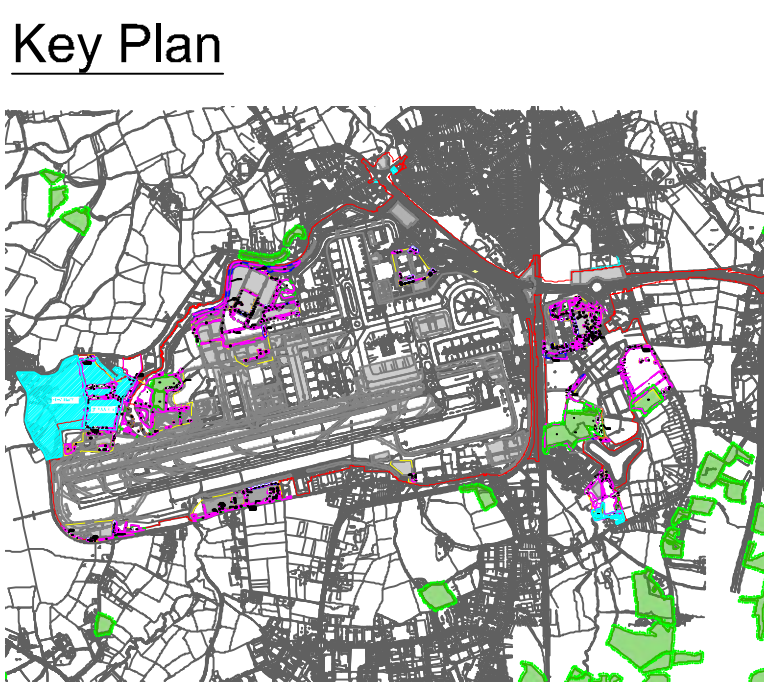

DOCUMENT

### Environmental Statement

DRAWING TITLE  
**Airport Preliminary Tree Removal & Protection Plans**  
 Appendix 5.3.2 Annex 6  
 Sheet 4 of 13

DATE  
 June 2024

ORIENTATION	DRAWING NO.	REVISION
N	753	For ES Issue
	RC	PIA / CHECKED BY DC

SCALE @ A0

Reproduced from Ordnance Survey map with the permission of Ordnance Survey on behalf of the controller of Her Majesty's Stationery Office © Crown Copyright (2023). Licence number 610031673, 100048492.  
 © Copyright 2023 Gatwick Airport Limited. No part of this drawing is to be reproduced without prior permission of Gatwick Airport Limited.





- Key**
- Site boundary
  - Survey boundary
  - Tree with numbered reference. Canopy spread and coloured BS5837:2012 tree quality category as shown below.
    - = Tree details estimate (accessible tree)
    - = Tree in off site location
  - Tree group plotted with individual stem locations and numbered reference. Canopy extents coloured to match BS5837:2012 tree quality category as shown below
  - Tree or vegetation group with numbered reference. Canopy extents coloured to match BS5837:2012 tree quality category as shown below and dashed line to show indicative stem line.
  - Hedge with numbered reference. Canopy extents and coloured BS5837:2012 tree quality category as shown below and dashed line to show hedge centreline.
  - Woodland with numbered reference. Canopy extents coloured to match BS5837:2012 tree quality category as shown below and dashed line to show indicative tree line.
- BS 5837:2012 Tree Quality Categories - Table 1**
- Category A - High quality
  - Category B - Moderate quality
  - Category C - Low quality
  - Category U - Unsuitable for retention
- Direction of first significant branch
  - Root protection area (RPA) Calculated in accordance with Section 4.6.1 BS5837:2012
  - Victorian tree buffer (15 x stem Ø) (as per standing advice produced by Forestry England and Natural England)
  - Tree protected by Tree Preservation Order
  - Designated Ancient Woodland (as per Natural England ancient woodland inventory, via open data publication)
  - Ancient Woodland tree buffer (15m offset) (as per standing advice produced by Forestry England and Natural England)
  - Projected tree loss required for construction of the Project (worst case scenario)
  - Indicative Scheme Layout
  - Indicative temporary protective fence line in accordance with Section 6.2 BS5837:2012. See below for example barriers.
  - Indicative secondary protective H/V Mesh fencing in accordance with Section 6.2 BS5837:2012. See below for example barriers.
  - Indicative vegetation protective fencing. Design and location to be agreed by local council during detail design.

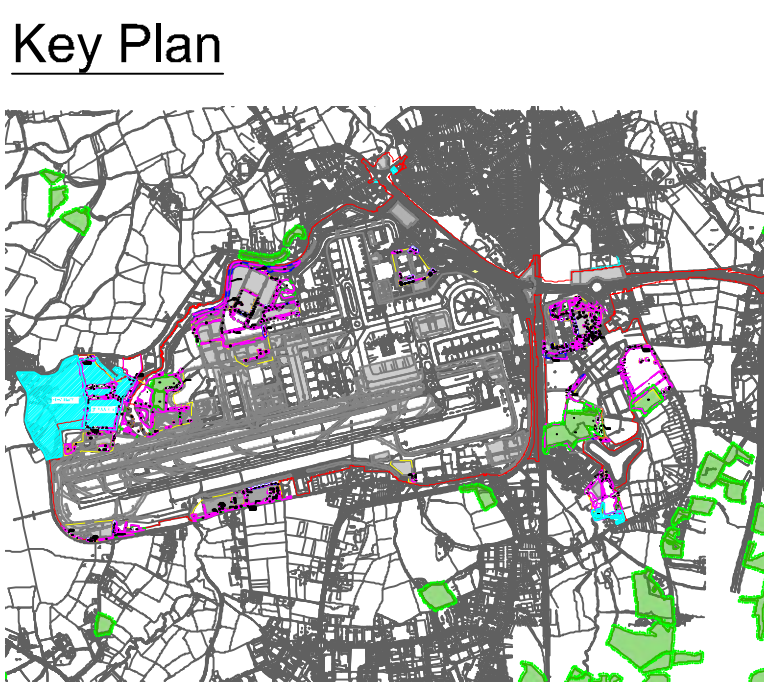
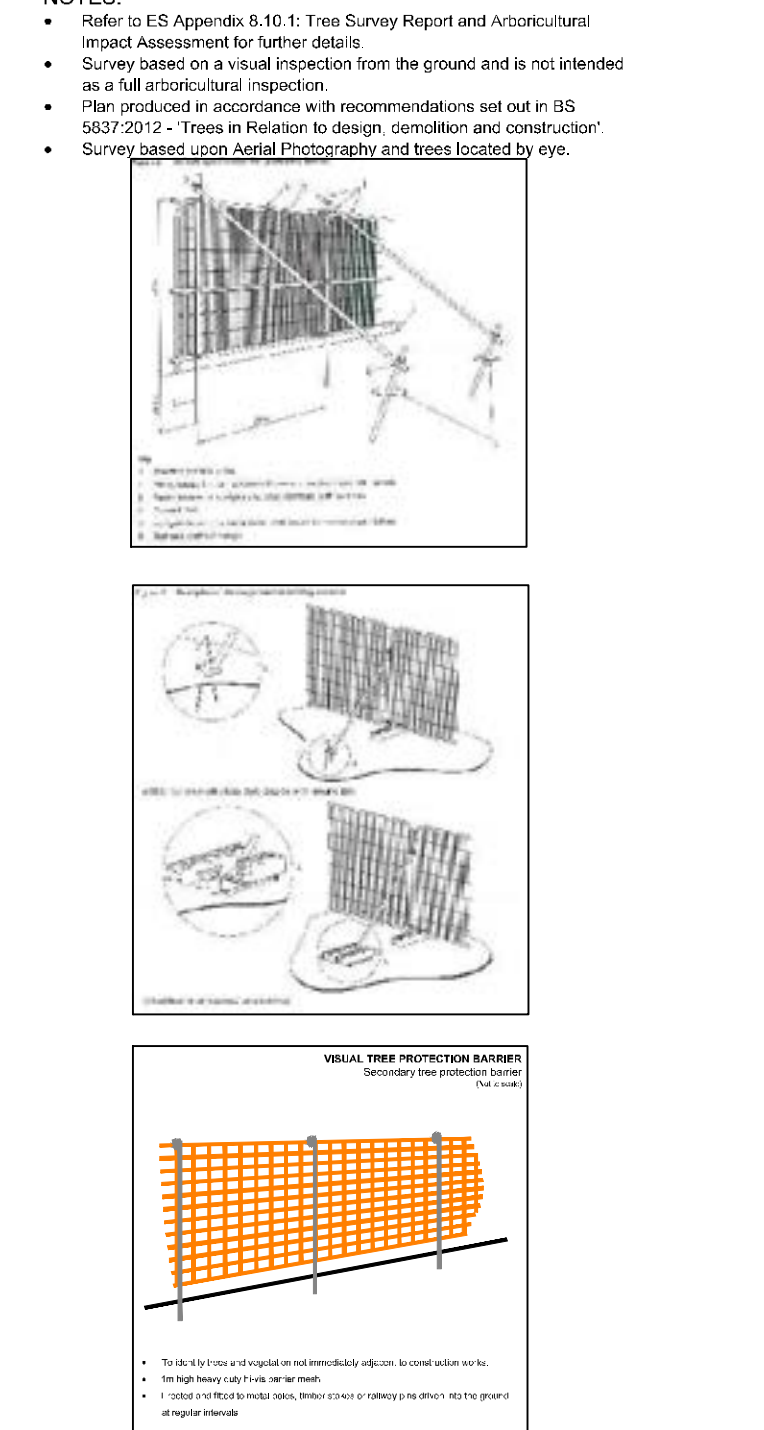

DOCUMENT

**Environmental Statement**

DRAWING TITLE

**Airport Preliminary Tree Removal & Protection Plans Appendix 5.3.2 Annex 6 Sheet 5 of 13**

DATE

**June 2024**

ORIENTATION	DRAWING NO.	REVISION
	754	For ES Issue
N	DRAWN BY	PIA / CHECKED BY
	RC	DC

SCALE @ A0

0m 25m 50m

Reproduced from Ordnance Survey map with the permission of Ordnance Survey on behalf of the controller of Her Majesty's Stationery Office © Crown Copyright (2023). Licence number 6100031673, 100048492. © Copyright 2023 Gatwick Airport Limited. No part of this drawing is to be reproduced without prior permission of Gatwick Airport Limited.